Bracket Part #	785	70411036	276 R	2475650
When Used	Wood Rollers	Metal Rollers	Reverse Roll OB Wood Rollers	Reverse Roll Metal Rollers

1 Mount the Brackets

You may attach the brackets to the window frame, window moulding, wall or ceiling as shown below. When measuring and installing spring roller shades make sure there is roughly 1/8" play between the roller and the brackets. Shades mounted too tightly in the brackets will not function properly.

If you are using #785 brackets, attach slotted bracket to the left and bracket with 2 circular holes to the right.

If you are using #70411036 brackets, both brackets are interchangeable.

If you are using #276 R Reverse Roll brackets, attach the slotted bracket to the right and the circular hole bracket to the left.

If you are using #2475650 Reverse Roll brackets, attach the locking tab bracket to the right and the basic bracket to the left.

Inside Mount Note:

Allow 1/4" inch clearance between top of frame and fully rolled-up shade. This will allow shade to be lifted and inserted into brackets.



Outside Mount Note:

Hold Shade to desired position (making sure its level) and place pencil marks at base of pin at each end of the roller. Alternately, mount the brackets where you originally measured prior to ordering the shade once again making sure they are level.

2 Mounting the Shade

The "Pin End" of the shade is to be inserted first into the right bracket. Then insert the "Spear End" (Spring End) into the notch of the left bracket.

Note: If the shade is too narrow you have the ability to make it up to 1/4" wider by pulling the "Pin End" out with pliers.

How to Adjust Spring Tension

To Tighten: Lower the shade about 18" from the top. Remove from brackets. Roll up shade all the way up by hand then replace in brackets. Pull shade down to test if you have reached the desired tension. If shade is still to loose, repeat this instruction.

To Loosen: Raise the shade to the top and remove from brackets. Unroll the shade about 18" and replace in brackets. Pull shade down to test if you have reached the desired tension. If shade is still to loose, repeat this instruction.

Note: If the shade refuses to roll up, the spring is too loose. When the shade will not stay down, the spring is too tight.

Caution: Over-tightening the spring may result in permanent damage. Do not use pliers to adjust the spring.

How to Fix Shade Telescoping

- If the fabric is crashing into the right bracket, roll the shade all the way down and apply tape layer by layer to the roller on the left side until problem diminishes.
- If the fabric is crashing into the left bracket, roll the shade all the way down and apply tape layer by layer to the roller on the right side until problem diminishes.

Note: Minimal fabric telescoping is ok as long as the fabric does not come in contact with the brackets.

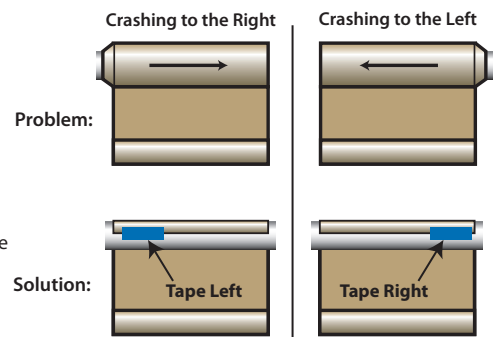

Installing Spring Shades with Fascia

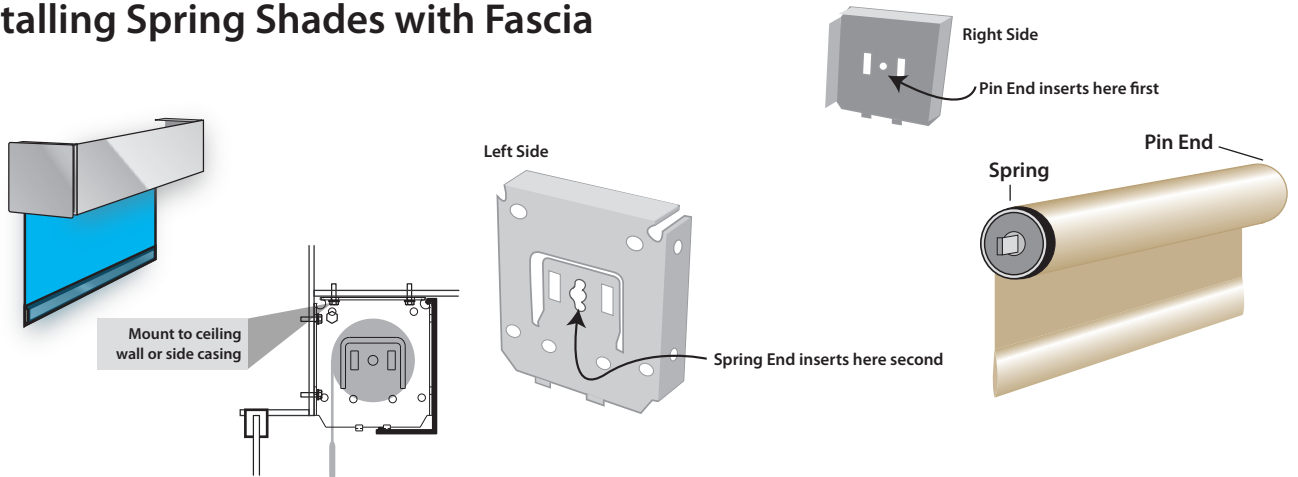

1 Mount the Brackets

The open end of each bracket faces downward as shown here: Brackets can be mounted up, back or to the side of a jamb.

2 Install the shade

First insert the spring loaded pin end idler into the right hand brackets center hole. Second insert the spear of the spring (on the left side) into the center elongated notch in the bracket.

3 Adjust Roller Tension

If Roller Shade is not rolling back up swiftly and the Spring needs to be tightened then pull the shade approximately 18" down from the top. Then Remove Shade from Brackets and roll the shade back up by hand. Place shade back into brackets and operate. You should notice a tighter feel. This will correct your tension. Repeat this step until shade tension is appropriate for you.

4 Attach Fascia Panel

First hook the top lip of the fascia panel onto the bracket as shown. Swing the bottom of the fascia panel towards the bracket and gently press at the bottom of the panel until the lip of the fascia engages and locks into the bracket.

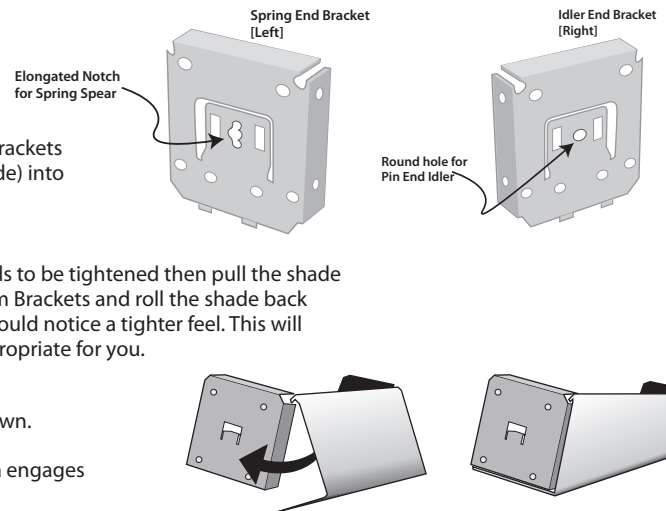

Installing Spring Shades with Cassette

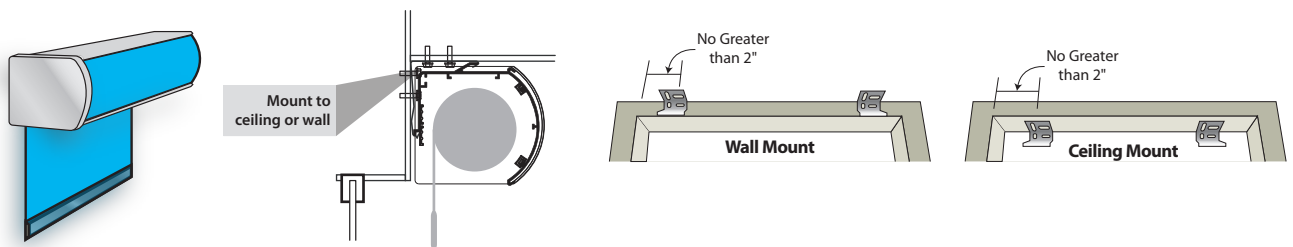

1 Mount the Brackets

Mount the brackets to the wall or window frame, with the outside brackets no further than 2" from the ends of the headrail. On wide shades, space the additional brackets supplied at equal intervals.

2 Mount the Headrail

Position the headrail with the front panel (A) resting on the top lip of all the brackets. Push the bottom front of the headrail firmly backwards and toward the window until the lip on the rear of the headrail engages the bracket and snaps into place, (B) as shown.

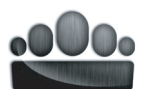
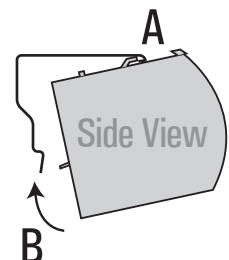

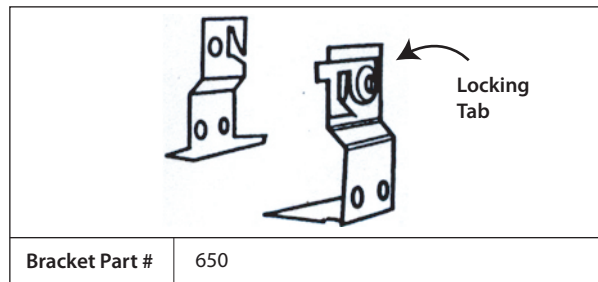

1 Mount the Brackets

You may attach the brackets to the window frame, window moulding, wall or ceiling. When measuring and installing spring roller shades make sure there is roughly 1/8" play between the roller and the brackets. Shades mounted too tightly in the brackets will not function properly.

Mount the bracket with the locking tab on the side with the spring (regular roll - right, reverse roll - left).

Inside Mount Note:

Allow 1/4" inch clearance between top of frame and fully rolled-up shade. This will allow shade to be lifted and inserted into brackets.



Outside Mount Note:

Hold Shade to desired position (making sure its level) and place pencil marks at base of pin at each end of the roller. Alternately, mount the brackets where you originally measured prior to ordering the shade once again making sure they are level.

2 Setting the Spring Tension

Holding the shade up right, wind the spear of the spring in the direction shown in the illustration to the right. The amount of rotations will depend on the height of the shade. If more or less tension is needed following step 4, remove the shade from the brackets and repeat this step.

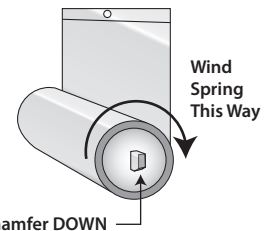

3 Mounting the Shade

The "Pin End" of the shade is to be inserted first into its bracket. Then insert the "Spear End" (Spring End) with the chamfered edge facing DOWN into the notch of the locking tab bracket.

4 Mounting the Pulley

Next, mount the pulley to the upper casing directly above the center (over the eyelet on the hem of the shade). Tie a knot in the supplied cord and thread the opposite end through the eyelet on the hem of the shade then up through the cord lock pulley. Finally attach the tassel to the end of the cord. Now to place the shade under constant tension pull the cord to raise the shade up. The spring is now permanently under tension and the cord lock pulley is the device keeping the fabric band in your desired position.

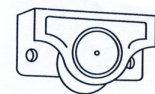

How to Fix Shade Telescoping

- If the fabric is crashing into the right bracket, roll the shade all the way down and apply tape layer by layer to the roller on the left side until problem diminishes.
- If the fabric is crashing into the left bracket, roll the shade all the way down and apply tape layer by layer to the roller on the right side until problem diminishes.

Note: Minimal fabric telescoping is ok as long as the fabric does not come in contact with the brackets.

