

Semi-Auto Cordless Spring Roller Shade Installation Instructions

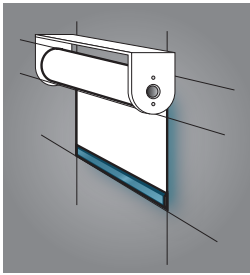

With a slight pull on the hem bar, the Semi-Auto cordless spring roller shade will automatically retract at a steady speed to a predetermined open position. Advanced updates to the traditional spring roller prevent over-cycling and unwinding at the top of the shade. You may also stop the shade band at any point as the shade is traversing up with another gentle pull of the hem bar.

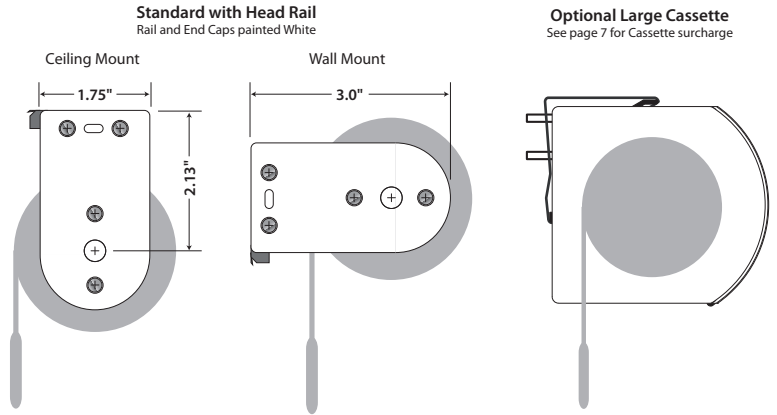

Standard Head Rail Systems

Shade Width	# Brackets
12"-40"	2
>40"-72"	3
>72"-84"	4
>84"-112"	5

Wall Mount Standard Head Rail

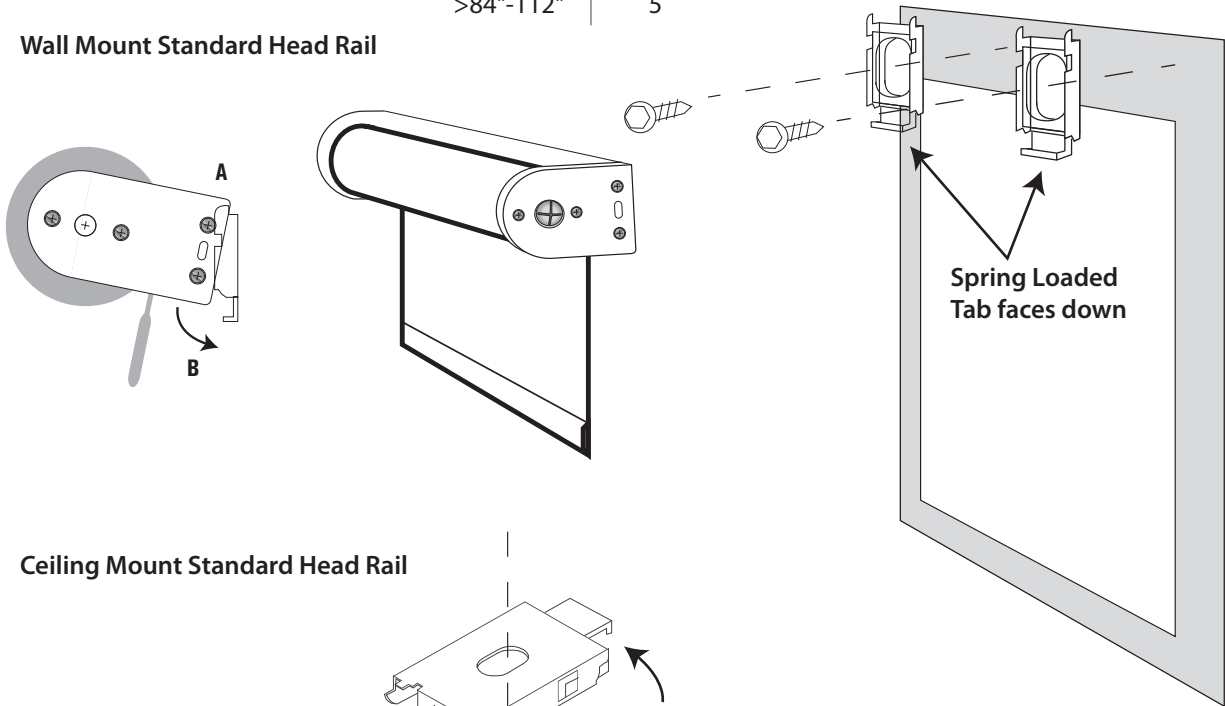

Ceiling Mount Standard Head Rail

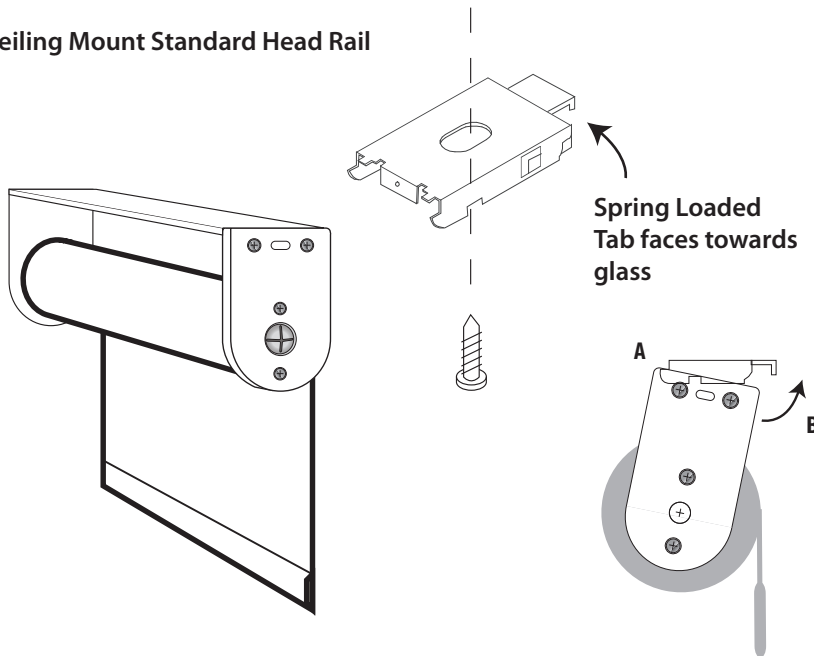

Removing a Standard Head Rail Shade
To remove a shade simply depress the spring loaded tab in towards the bracket and release the head rail from the bracket in the reverse manner as you did installing it.

Semi-Auto Cordless Spring Roller Shade **Installation Instructions**

Optional Cassette Head Rail System

Shade Width	# Brackets
12"-40"	2
>40"-72"	3
>72"-84"	4
>84"-112"	5

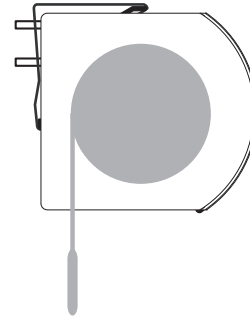

1 Mount the Brackets

Mount the brackets to the wall or window frame, with the outside brackets no further than 2" from the ends of the headrail. On wide shades, space the additional brackets supplied at equal intervals.

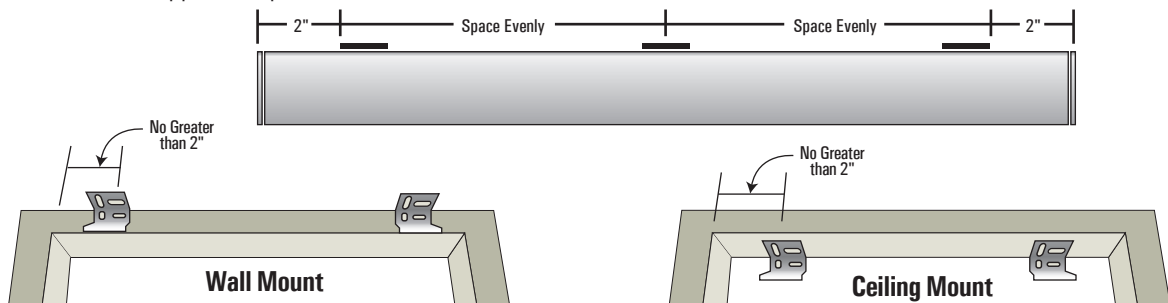

2 Mount the Headrail

Position the headrail with the front panel (A) resting on the top lip of all the brackets. Push the bottom front of the headrail firmly backwards and toward the window until the lip on the rear of the headrail engages the bracket and snaps into place, (B) as shown.

3 Removing a Cassette Shade

To remove a shade, from the bottom rear of the headrail insert a flat head screwdriver in between the headrail and bracket. Gently twist the screwdriver and pry open the bracket to release the headrail.

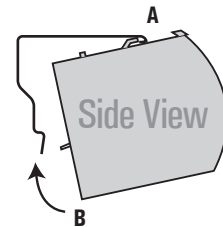

TENSION ADJUSTMENT

If the shade does not retract fully, you may need to increase the tension by using a **flat head** screwdriver.

On a STANDARD ROLL the adjustment is made at the LEFT end of the shade.
On a REVERSE ROLL the adjustment is made at the RIGHT end of the shade.

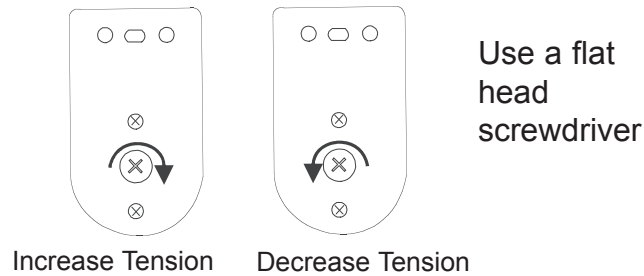

UPSTOP ADJUSTMENT

Retract the shade and let it stop at the top. If you do not like where the upstop is set it can be adjusted, using a **flat head** screwdriver.

On a STANDARD ROLL the adjustment is made at the RIGHT end of the shade.
On a REVERSE ROLL the adjustment is made at the LEFT end of the shade.

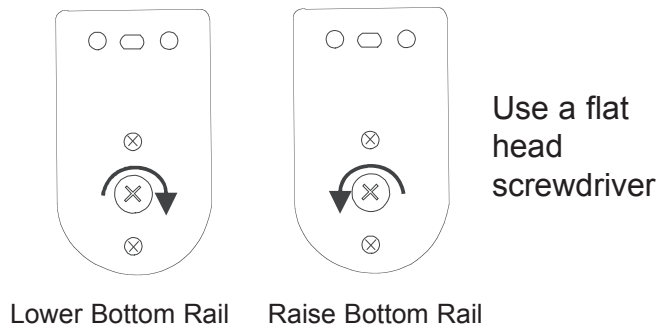

Be sure your shade is fully raised before making adjustments.

